



ADDENDUM NO. 2

Project:	Monon Center Indoor Playground	Project Number:	2023-020
Location:	195 Central Park Dr W. Carmel, IN 46032	Date Prepared:	26 April 2024
Owner:	Carmel Clay Parks and Recreation	Bid Package:	
		Distributed to:	ALL PLAN HOLDERS

NOTE: The following changes are hereby made to the Contract Documents and insofar as the original Contract Documents are inconsistent therewith, the changes herein shall govern. All bidders shall acknowledge this Addendum by inserting its number and dater on their Bid Proposal.

GENERAL:

Question period and Substitution Period is now closed. This will be the final addenda.

1. In the Instruction to Bidders, 6.1.4 the bid submission requires references of five previous projects of similar scope and size. Confirm this is required with the Bid Submission or can be Post Bid information?
 - a. References may be provided post bid. The 2 Apparent low bidders must provide references within 24 hours of bid opening.
2. The Bid Form Part 2 of the proposal 2.3 Schedule of Values to be submitted with the bid. In a competitive bid situation, this is very difficult to provide with a bid when we don't know until the last minute who the low subcontractor is and what their bid is. Can this SOV be provided post bid along with Post Bid Submittals as there is plenty of other Bid Submission items that are already required in the bid.
 - a. Schedule of Values may be provided post bid. The 2 Apparent low bidders must provide references within 24 hours of bid opening.
3. Can the existing sidewalk leading from the circle Drop Off be used as exterior access to the project area? Also, can a dumpster be left along the circle drop off if properly barricaded for demo and general debris use? There appears to be no other location close to set a dumpster without damaging the landscaping and provide delivery and pick up access.
 - a. This is acceptable. Final Location of Dumpster to be coordinated with Owner in Field.
4. It appears via Addendum #1 the Play Structure vendor is providing and installing the baseplate anchors, however is the Play Structure vendor also grouting his own column base plates?
 - a. Contractor to precast anchors at locations provided by Play Structure installer. Contractor may assume 4 anchors at each location with the quantity of locations indicated on plans. Play Structure installer to install baseplates and leveling.
5. Is Owner of contractor carrying the cost for material testing of soils and concrete?
 - a. Contractor to engage a 3rd party testing agency for code required testing and provide owner with inspection reports.
6. Has the Play Structure been ordered and what is the delivery lead time and installation schedule?
 - a. The final order for the play structure will be approved at the same time as the bids for the project, the anticipated arrival date is November 2024.
7. I assume it is at contractor's option if he wants to remove the existing TZ floor under the wood floor verses leveling the existing slab?

- a. The Contractor may elect to remove the Terrazzo in lieu of providing leveling.
8. What is the intent and expected use of Spec section 090561.13 Moisture Vapor Emission Control? Is this intended to be used at the slab replacement area and not expected at areas of existing slab where flooring is being removed?
 - a. The New Slab should include admixture to capture moisture in new concrete. Existing slab should be tested for compatibility and credit to be issued to owner if mitigation is not needed.
9. Who is to supply and install the Vinyl Graphic Tree's shown on the Youth Area Walls?
 - a. Contractor to provide. Vinyl Film: UV-resistant vinyl film with pressure-sensitive, permanent adhesive; die cut to form characters or images as indicated on Drawings suitable for interior application on windows, drywall, plywood, and block walls. Apply graphics to back face of clear face-sheet material to produce precisely formed image. Image shall be free of rough edges. Graphic will be made up of 2 colors. 1 color for base/branches. 1 color for the top. Color may vary for each "tree". Elevations may be used as a general scale for the graphics.
10. Please confirm that the existing roof deck underside gets painted after the renovations are complete?
 - a. The roof deck underside is not called to be painted.
11. Confirm the Play Structure vendor is making the welded connections to the existing steel structure above as Summary of Work, 1.7, B seems to imply the Bidding Contractor is making connections to the steel above for the Play Structure?
 - a. Revise to be Contractor to weld 3 Connection Tabs, provided by play structure manufacturer, to existing structure at locations indicated by play structure manufacturer.
12. Can you provide more Details on the Tree?
 - a. See image for a similar installation. CAD files can be provided to selected contractor for the shapes of the "trunk"



DRAWINGS:

Listed Items are meant as an overview of changed. Refer to Sheets for complete revisions.

1. A1.1 (Not Reissued) North Wall of Storage 108 is Wall Type A1

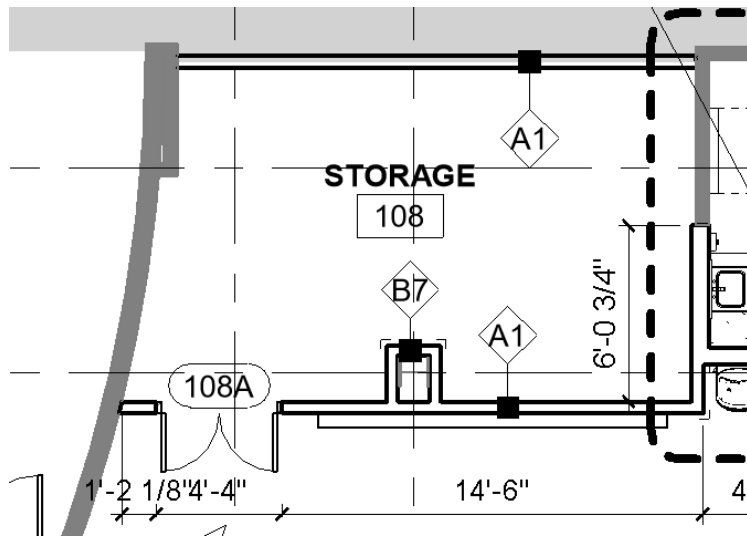

PROJECT MANUAL:

1. 033000- Cast in place concrete

- a. MVRA 900 by ISE Logik is an approved alternate to Barrier One under 2.5 Concrete Water Vapor Reducing Admixture.

ENCL: Listed

Distribution: Eastern Engineering

Prepared by: SL

End of Addendum