

5A	FLASHING:	ETHYLENE PROPYLENE DIENE MONOMER (EPDM)
5B	SURFACE:	SMOOTH
	MEMBRANE:	60 MIL NON REINFORCED EPDM FULLY ADHERED
	INSULATION:	TAPERED POLYISOCYANURATE INSULATION (2" START) MECHANICALLY ATTACHED
	VAPOR BARRIER:	NA
	DECK:	1 1/2" TYPE B METAL DECK

ROOF PRESSURES ASCE 7-10

ROOF FIELD	- 41.71 POUNDS PER SQUARE FOOT
ROOF PERIMETER	- 69.98 POUNDS PER SQUARE FOOT
ROOF CORNERS	- 105.33 POUNDS PER SQUARE FOOT

EDGE METAL PRESSURES ANSI SPRI ES-1 2011

VERTICAL PERIMETER PRESSURE	- 88.87 POUNDS PER SQUARE FOOT
VERTICAL CORNER PRESSURE	- 133.84 POUNDS PER SQUARE FOOT
HORIZONTAL PERIMETER PRESSURE	- 51.31 POUNDS PER SQUARE FOOT
HORIZONTAL CORNER PRESSURE	- 64.01 POUNDS PER SQUARE FOOT

WOOD NAILERS ARE TO BE INSTALLED IN ACCORDANCE WITH ANSI-SPRI ES1 2011. APPROPRIATE WIND LOAD SAFETY FACTORS ARE TO BE USED BASED ON THE TABLE BELOW

WIND LOAD SAFETY FACTORS

WOOD	4.5
MASONRY	3.0
STEEL	1.9

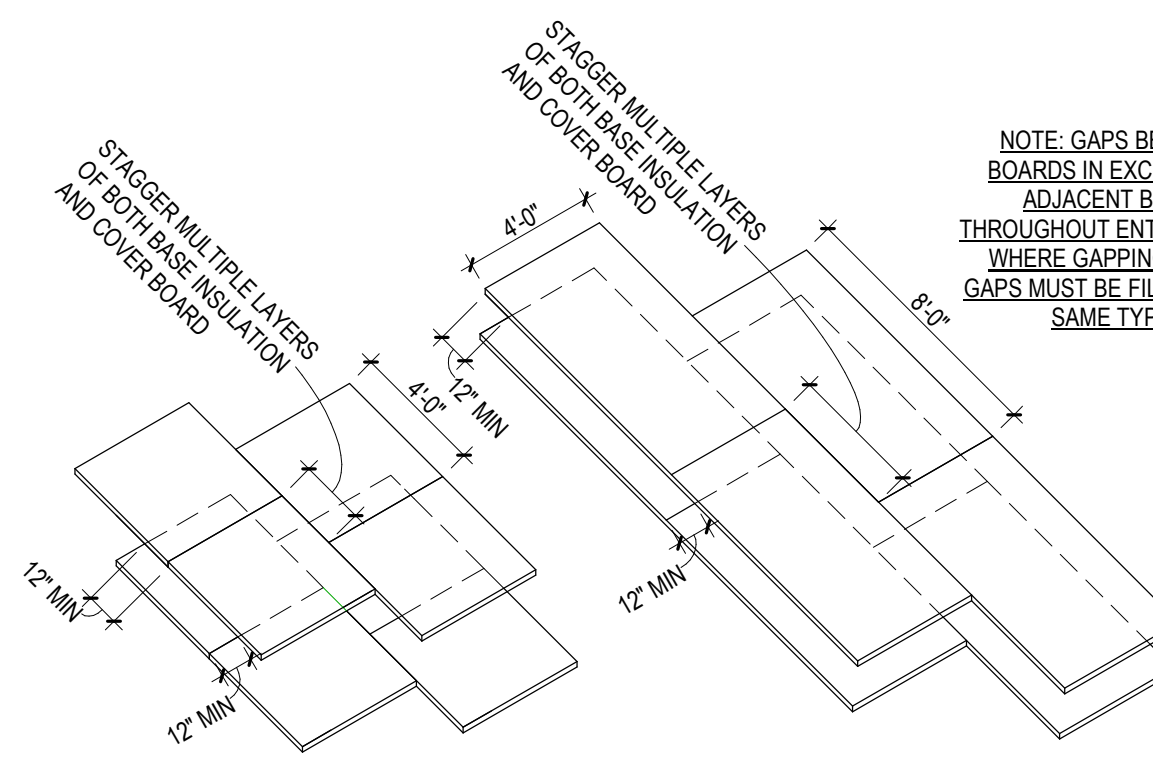

NOTE: GAPS BETWEEN ADJACENT INSULATION BOARDS IN EXCESS OF 1/8\"/>

5 Existing Conditions
N.T.S.

4 Design Uplift Pressures
N.T.S.

3 Insulation Overlap
N.T.S.

General Notes

- CONTRACTOR AND/OR SUBCONTRACTORS SHALL NOT STAGE AND/OR STORE MATERIALS ON EXISTING ROOF SYSTEMS THAT ARE NOT PART OF THIS WORK, AS NOTED ON ROOF PLANS. IF APPROVED BY OWNER/ARCHITECT TO STORE MATERIALS OR TRAFFIC OVER N.I.C. ROOF AREAS, PROVIDE PROTECTION BOARD (1/2" PLYWOOD OVER 2" XPS).
- CONTRACTOR AND/OR SUBCONTRACTORS SHALL NOT TRAFFIC ACROSS ROOF SYSTEMS THAT ARE NOT PART OF THIS WORK, AS NOTED ON ROOF PLANS.
- CONTRACTOR IS RESPONSIBLE FOR VERIFYING ALL DIMENSIONS AND DETAILS THAT AFFECT THIS WORK.
- CONTRACTOR STAGING AREA SHALL BE KEPT CLEAN AND ORGANIZED. PROVIDE SOME FORM OF FENCING AROUND STAGING AREA(S) TO PREVENT PEDESTRIAN TRAFFIC.
- PROVIDE PROTECTIVE BARRIER BENEATH ANY ROOFING VEHICLES OR EQUIPMENT TO PREVENT DAMAGING AND/OR STAINING OF EXISTING ASPHALT OR CONCRETE WALK WAYS.
- CONTRACTOR SHALL DOCUMENT (PHOTOGRAPH AND MARK ON SITE PLAN) EXISTING DEFECTS AND/OR DAMAGE TO EXISTING WALK WAYS PRIOR TO COMMENCEMENT OF WORK. A COPY OF EXISTING CONDITIONS DOCUMENTATION SHALL BE PROVIDED TO ROOF CONSULTANT FOR RECORDS.
- CONTRACTOR RESPONSIBLE FOR PROTECTING AND REPAIRING ALL LANDSCAPING DAMAGED DUE TO CONSTRUCTION UP TO EXISTING CONDITION OR BETTER.

Plan Work Description Notes Base Work

- NO WORK AND/OR MATERIALS TO BE STORED/PERFORMED IN THIS AREA
- REMOVE EXISTING (EXG) ETHYLENE DIENE PROPYLENE MONOMER (EPDM) ROOFING, INSULATION, FLASHINGS (FLG), CAPS AND STRIPPINGS. INSPECT EXG METAL DECK FOR DAMAGE OR DETERIORATION AND REPORT CONDITIONS TO ROOF CONSULTANT. AREAS <5A>, AND <5B> - SEE EXISTING CONDITIONS 5R101
- REMOVE EXG ABANDONED (ABD) CURBS. IF OPENING IS SMALLER THAN 12", COVER HOLE IN DECK WITH NEW 18 GAUGE METAL PLATE. EXTEND PLATE 6" BEYOND OPENING AND MECHANICALLY ATTACH PLATE TO DECK. IF OPENING IN ROOF DECK IS LARGER THAN 12" PATCH HOLE IN DECK WITH NEW METAL DECKING TO MATCH EXISTING. SPAN NEW METAL DECKING TO ADJACENT JOIST (MAX SPAN 30" C/C). AREAS <5A>, AND <5B>
- REMOVE ALL EXG PLUMBING VENT (PV) FLGS. REMOVE, SALVAGE, AND REINSTALL EXISTING CHARCOAL FILTERS (2) AT EXISTING PLUMBING VENTS. EXTEND WITH PVC AND INTERNAL COPLING TO ACCOMMODATE NEW 12" MINIMUM HEIGHT. PROVIDE NEW FSR PREFORMED FLASHING BOOT. AREAS <5A> AND <5B> - SEE DETAIL 4R103
- REMOVE EXG METAL COPING AND ALL ACCESSORIES IN THEIR ENTIRETY. PROVIDE NEW PREFINISHED GI COPING WITH CONTINUOUS GI COPING CLIP. AREAS <5A> AND <5B> - SEE DETAIL 6R102
- ALL EXG POWER ROOF VENTILATORS (PRV), GRAVITY ROOF VENTILATORS (GRV) AND OTHER ROOF TOP EQUIPMENT TO REMAIN AT EXISTING HEIGHT. REFASTEN EXISTING CURB CAPS WITH NEW GASKETED FASTENERS (2 FASTENERS PER SIDE) AND AT ALL EXISTING HOLES IN FLANGE. AREAS <5A>, AND <5B> - SEE DETAIL 1R103 AND 2R103
- RESET ALL EXISTING (RD) CLAMPING RINGS AND STRAINERS IN NEW FLEXIBLE SHEET ROOFING FLG. REMOVE AND REPLACE ANY MISSING AND/OR BROKEN COMPONENTS WITH NEW CAST IRON COMPONENTS. REPLACE ALL PLASTIC STRAINERS WITH NEW CAST IRON STRAINERS. AREA <5A> AND <5B> - SEE DETAIL 3R103 AND 3.1R103
- EXG ROOF TOP UNIT (RTU) TO REMAIN. PROVIDE NEW 20 GA SLIP FLASHING MECHANICALLY ATTACHED TO EXG CURB AT 12" O/C MAXIMUM. AREAS <5A> - SEE DETAIL 5R103
- EXISTING METAL COPING AND ALL ACCESSORIES IN THEIR ENTIRETY TO REMAIN. AREA <N.I.C.>
- CUT DOWN EXISTING OVERFLOW PIPE STUB BELOW ROOF DECK AND INSTALL A NEW CAST IRON DRAIN BOWL WITH OVERFLOW CLAMPING RING - INSULATE OVERFLOW DRAIN BOWL AND TIE INTO EXISTING DRAIN LINE INSULATION. PROVIDE NEW CAST IRON STRAINER. AREAS <5A>, AND <5B> - SEE DETAIL 3R103 AND 3.1R103
- EXISTING (4) INTERLOCKING WALKWAY PADS (WP) TO REMAIN AS INDICATED ON ROOF PLAN. AREA <5A>
- PROVIDE NEW TREATED 2x WOOD AREA SEPARATION CURB WITH NEW 24 GA PREFINISHED GI AREA SEPARATION CAP. AREA <5A> - SEE DETAIL 3R102
- PROVIDE (28) NEW 24"x24"x2" INTERLOCKING WALKWAY PADS (WP) AS INDICATED ON ROOF PLAN. AREA <5A>
- PROVIDE NEW CONCRETE SPLASH BLOCK (SB) WITH SLIP SHEET AT EXG DOWNSPOUT (DS). AREA <5A>
- PROVIDE NEW TREATED 2x WOOD AREA SEPARATION CURB WITH NEW 24 GA PREFINISHED GI AREA SEPARATION CAP (IF ALTERNATE IS NOT TAKEN). IF ALTERNATE IS TAKEN AREA SEPARATION IS NOT REQUIRED AND TREAT CONDITION AS RIDGE AND PROCEED WITH TAPER PLAN. AREAS <5A>, AND <5B> - SEE DETAIL 3R102
- REMOVE EXISTING WALKWAY PADS (WP) AS INDICATED ON ROOF PLAN. AREA <5A>
- PROVIDE NEW 1/4-1/2 TAPERED INSULATION SADDLES WITH 6" TAPERED EDGE STRIP. AREAS <5A>, AND <5B>
- PROVIDE NEW FLEXIBLE SHEET ROOFING (FSR) FLASHINGS AND STRIPPINGS. AREAS <5A>, AND <5B>
- PROVIDE NEW MECHANICALLY ATTACHED 1/8"-1/2" TAPERED RIGID INSULATION (START THICKNESS 2" - 1 1/2" BASE LAYER OF INSULATION WITH 0.5" TAPERED INSULATION OVER TOP) (AVG R=22.50). NEW ADHESIVELY ADHERED COVER BOARD (R=2.5) AND NEW ADHESIVELY ADHERED FLEXIBLE SHEET ROOFING (EA-FSR). AREAS <5A> AND <5B> - SEE DETAIL 3R101
- REMOVE EXISTING METAL COPING AND ALL ACCESSORIES IN THEIR ENTIRETY. PROVIDE NEW PREFINISHED GI CORNER COPING TRANSITION PIECE WITH CONTINUOUS GI COPING CLIP. AREA <5A>
- REMOVE EXISTING GAS LINE DOWN BELOW DECK. CAP OFF GAS LINE BACK TO NEAREST TRANSITION. AREA <5A>
- AT LOCATIONS WHERE RIDGE IS OFFSET, PROVIDE NEW ADHESIVELY ADHERED TAPERED EDGE STRIP FOR A SMOOTH TRANSITION FOR MEMBRANE TO ADHERE UPON TO ACCOMMODATE THIS CHANGE IN INSULATION THICKNESS ALONG THE RIDGE. AREA <5A> AND <5B>
- PROVIDE NEW CONTRACTOR'S WARRANTY (2 YEAR) AND MANUFACTURER'S WARRANTY (30 YEAR). AREAS <5A>, AND <5B>

2025 Roofing Work at Sand Creek Elementary

Jennings County School Corporation

34 Main Street
North Vernon, IN 47265



221 West Baker Street
Fort Wayne, Indiana 46802
TEL. 260.422.7994
FAX. 260.426.2067

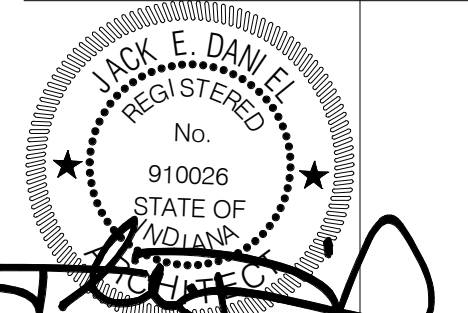

ALL DESIGN ORIGINATIONS AND/OR DESIGN DEVELOPMENT OF THE DRAWINGS COVERED BY THIS PROJECT IS THE PROPERTY OF MARTIN RILEY ARCHITECTS+ENGINEERS. NO PART OF THESE DRAWINGS IS TO BE REPRODUCED, COPIED, OR TRANSMITTED IN ANY FORM OR BY ANY MEANS, ELECTRONIC OR MECHANICAL, WITHOUT THE WRITTEN PERMISSION OF MARTIN RILEY ARCHITECTS+ENGINEERS. THE USER OF THESE DRAWINGS IS TO BE RESPONSIBLE FOR OBTAINING ALL NECESSARY PERMITS AND APPROVALS FROM THE APPROPRIATE AGENCIES. THE USER OF THESE DRAWINGS IS TO BE RESPONSIBLE FOR OBTAINING ALL NECESSARY PERMITS AND APPROVALS FROM THE APPROPRIATE AGENCIES. THE USER OF THESE DRAWINGS IS TO BE RESPONSIBLE FOR OBTAINING ALL NECESSARY PERMITS AND APPROVALS FROM THE APPROPRIATE AGENCIES.

REVISION	DATE
1	Corrs
	12/16/2024

DRAWN BY: CLW
COMMISSION NUMBER: F24088
REVIEWED BY: MWH
DATE: 2024-11-26

R101

ROOF PLAN

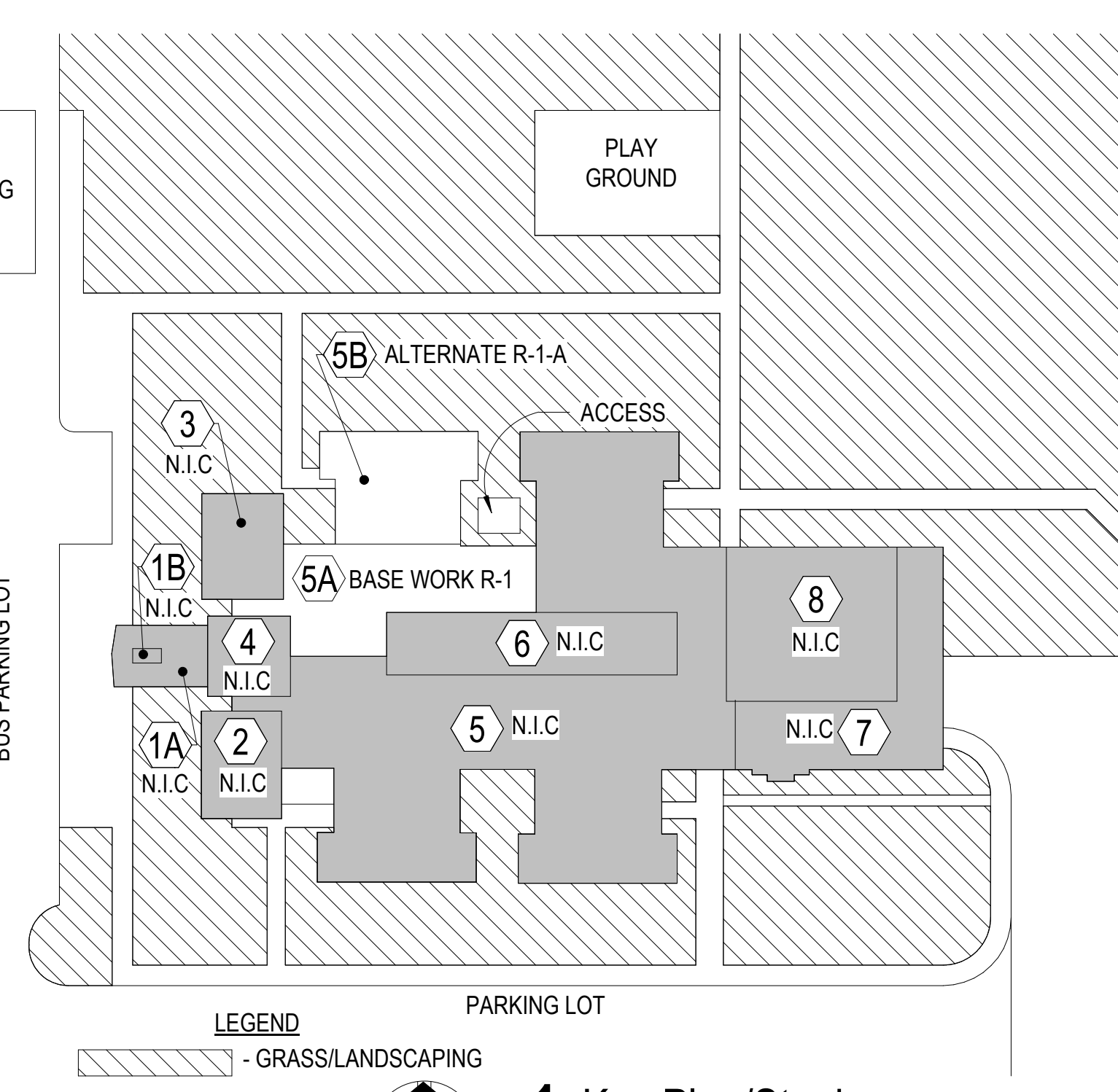

1 Key Plan/Staging
N.T.S.

CONTRACTOR IS RESPONSIBLE FOR VERIFYING ALL DETAILS AND DIMENSIONS THAT AFFECT THIS WORK

F24088 - Jennings County School Corporation
C:\Users\cwh\Documents\SandCreekElementary_cwh\R101.rvt
SD:DDCDD