

DC# 2026 0022
Lakeland School Corporation
Wolcott Mills Elementary Reroof
Addendum No. 1
May 11, 2026

1. **Item No. A-1**

- a. Drawing Sheet Reference: A2.1-Roof Plan
- b. Alternate: No. 1-TPO Reroof
- c. Specification Section: Note #1-Field Discovery Report
- d. Addendum Item: Existing Structural Roof Deck

Clarification: The existing structural roof deck is a 2-1/4" to 2-1/2" thick tongue and groove Lock Deck. The underside of the Lock-Deck is exposed to interior occupied spaces. Lock-Deck is supported by exposed deep wood roof trusses



2. **Item No. A-2**

- a. Drawing Sheet Reference: A2.1-Roof Plan
- b. Alternate: No. 1-TPO Reroof
- c. Specification Section: Note #3-New Roof Membrane Manufacturers
- d. Addendum Item: Acceptable roof membrane manufacturers

Add Durolast Roofing as an acceptable TPO roofing membrane manufacturer to the list of the (3) acceptable manufacturers for a total of (4) acceptable manufacturers.

3. **Item No. A-3**

- a. Drawing Sheet Reference: A2.1-Roof Plan
- b. **Alternate: No. 1-TPO Reroof**
- c. Specification Section: Note #4-New Roof Assembly
- d. Addendum Item: Base Bid Roof System modifications
- e. Modifications, Clarifications & Notifications to the system include the following

Modification: To compensate for asphalt residue that may prevent proper adhesion of the specified vapor barrier, add ¼" x 48" x 96" Georgia Pacific Densdeck Prime substrate board or approved equal direct to the top of the structural Lock Deck. Secure panels with 1-1/2" long roofing membrane manufacturer approved deck screws. Fastener quantity and pattern to resist Class 90 wind uplift loading.

Clarification: The existing structural roof deck is a 2-1/4" to 2-1/2" thick tongue and groove Lock Deck. The underside of the Lock-Deck is exposed to interior occupied spaces. The design intent is that fasteners used as part of mechanically attached insulation boards shall not penetrate the underside of the exposed roof deck.

Clarification: Fasteners lengths to secure the tapered insulation panels will vary in length and their usage will need to be closely coordinated in the field to prevent fasteners from penetrating the underside of the decorative roof deck. It is highly recommended that installing contractors closely field supervise fastener length usage with their installing crews. Tapered insulation board fasteners shall penetrate the structural Wood Lock Deck a minimum of 1" to a maximum of 1-1/4".

Notification: Where fasteners extend through the underside of the Lock Deck the fasteners, at the contractor's expense for material and labor, shall be cut and grinded off to be slightly recessed. The tips of the fasteners to be spot primed. Holes to be filled with color matched epoxy wood filler or tinted wood plugs. Affected areas between trusses shall be sanded complete, pre-conditioned and re-stained with color matching stain.

Clarification: At the primary roof drain locations, Bidding contractors to assume a ¼" thick substrate board, vapor barrier, 1-1/2" flat stock fill panel and a tapered "X" panel for a total start thickness of 2-1/4" at the roof drains.

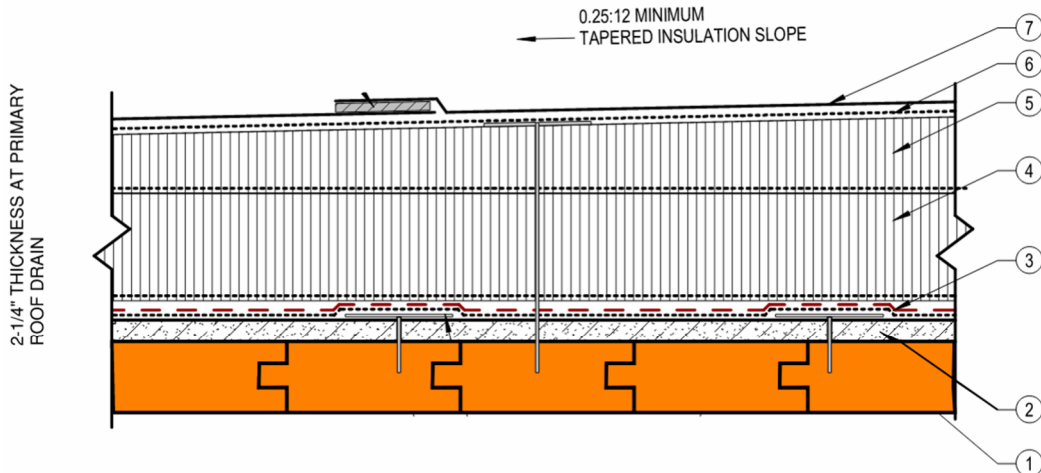

- 1. EXISTING 2-1/4" TO 2-1/2" LOCK DECK
- 2. 1/4" SUBSTRATE BOARD, MECHANICALLY ATTACHED WITH 1-1/2" LONG SCREWS
- 3. ADHERED VAPOR BARRIER
- 4. 1-1/2" POLYISOCYANURATE FILL PANEL LOOSE LAID
- 5. TAPERED POLYISOCYANURATE PANELS MECHANICALLY ATTACHED. MIN 1" TO MAX 1-1/4" FASTENER PENETRATION INTO STRUCTURAL DECK.
- 6. TPO ROOF MEMBRANE ADHESIVE
- 7. TPO ROOF MEMBRANE WITH HEAT WELDED SEAMS

4. **Item No. A-4**

- a. Drawing Sheet Reference: A2.1-Roof Plan
- b. **Alternate: No. 1-TPO Roof**
- c. Specification Section: Note #4 – New Roof Assembly to be bid as an Option to the Alternate No. 1 roof assembly.
- d. Addendum Item: An acceptable option to the specified TPO roof system includes the following:
 - Roof membrane materials & attachment methodology: Same as notated on A2.1
 - Tapered Insulation panels & attachment methodology: Adhered with adhesive per roofing membrane manufacturer recommendations. All other information remains the same as notated on A2.1.
 - Fill Panel Materials and attachment methodology: 1-1/2" fill panels adhered with adhesive per roofing membrane manufacturer recommendations. All other information remains the same as notated on A2.1.
 - Temporary Roof/ Vapor Barrier material & attachment methodology: Direct applied to a substrate board per roofing membrane manufacturer recommendations.
 - Substrate Board: To compensate for asphalt residue that may prevent proper adhesion of the specified vapor barrier, add 1/4" x 48" x 96" Georgia Pacific Densdeck Prime substrate board or approved equal direct to the top of the structural Lock Deck. Secure panels with 1-1/2" long deck screws. Fastener quantity and pattern to resist Class 90 wind uplift loading.
 - Structural Deck: The existing structural roof deck is a 2-1/4" to 2-1/2" thick tongue and groove Lock Deck. The underside of the Lock-Deck is exposed to interior occupied spaces. Lock-Deck is supported by exposed deep wood roof trusses
 - Clarification: At the primary roof drain locations, Bidding contractors to assume a 1/4" thick substrate board, vapor barrier, 1-1/2" flat stock fill panel and a tapered "X" panel for a total start thickness of 2-1/4" at the roof drains.

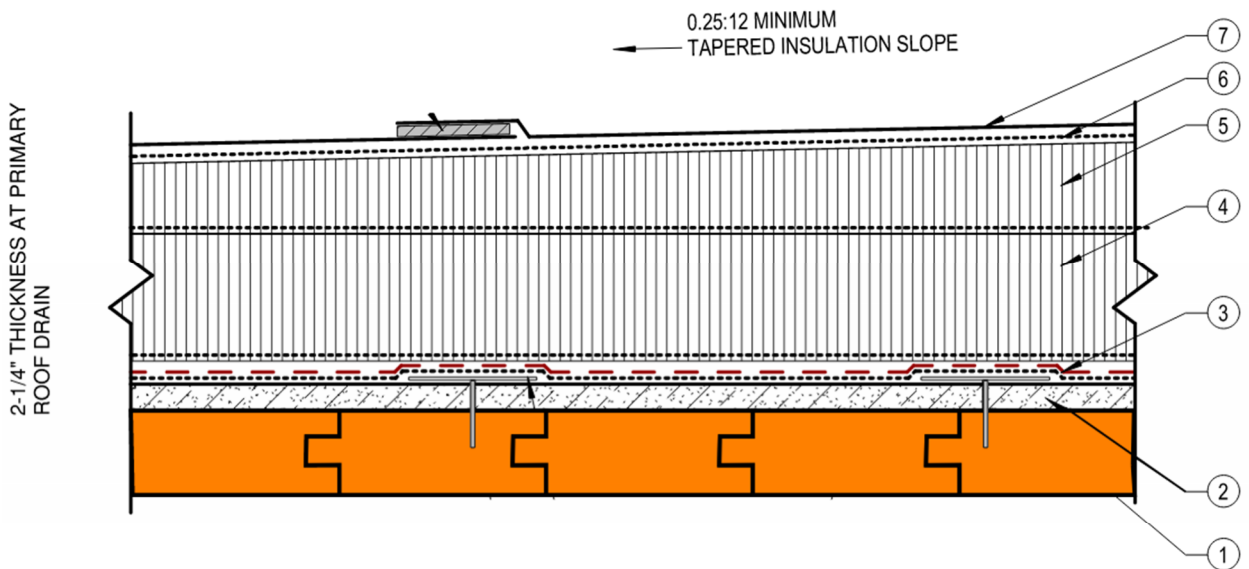

1. EXISTING 2-1/4" TO 2-1/2" LOCK DECK
2. 1/4" SUBSTRATE BOARD, MECHANICALLY ATTACHED WITH 1-1/2" LONG SCREWS
3. ADHERED VAPOR BARRIER
4. 1-1/2" POLYISOCYANURATE FILL PANEL ADHERED
5. TAPERED POLYISOCYANURATE PANELS ADHERED
6. TPO ROOF MEMBRANE ADHESIVE
7. TPO ROOF MEMBRANE WITH HEAT WELDED SEAMS

5. **Item No. A-5**

a. TPO Roof Assemblies

Roofing Contractor shall bid both Alternate 1 and Alternate 1A TPO Roof assemblies.

6. **Item No. A-6**

a. TPO Alternates 1 & 1A

Since there is a probability that existing sheet metal elevations, etc at perimeter roofing terminations may be impacted by the use of a ¼" tapered system, the Contractor shall also provide a cost for 1/8" sloped tapered panels in lieu of ¼" tapered panels.

7. **Item No. A-7**

a. Existing grass & landscape areas, "A"

b. Specification Section: Division #1

Add: If contractor elects to utilize equipment on existing unpaved areas that causes damage to landscaping, earthwork, or grass areas, they are solely responsible for fixing and repairing any damage to these existing conditions.

- This shall include re-grading, seeding, and infilling as required so it matches existing conditions prior to any construction work.
- If contractor elects to utilize lay down material, all ruts and repairs from any damage is to be repaired to match existing conditions prior to construction work.

8. **Item No. A-8**

a. Existing Roof Vents

b. Drawings note to re-use existing vents, however if contractor elects to replace with new, there is no concern with this. The new must match existing in color and match the quantity and airflow that is currently there today.

9. **Item No. A-9**

a. Metal Roof Alternate – 4

b. Clarification:

- i. Alternate to include the cost of 80'-0" linear of snowguard
- ii. Alternate to include the cost that the entirety of the coverage area for this alternate requires self-adhering, high temperature ice and water shield and ventilation.